

**THE COUNCIL OF THE BOROUGH OF MILTON KEYNES
(THE COUNCIL OF THE BOROUGH OF MILTON KEYNES (CENTRAL MILTON KEYNES) (ON-STREET SPECIFIC AND PERMIT PARKING PLACES) ORDER 2002) VARIATION ORDER 2009**

The Council of the Borough of Milton Keynes ("the Council") in exercise of the powers of the said Council under Sections 32(1), 35(1), 45, 46, 49, 53, 63 and Part IV of Schedule 9 of the Road Traffic Regulation Act 1984 ("the Act of 1984") and of all other enabling powers and after consultation with the chief officer of police in accordance with Part III of Schedule 9 hereby makes the following Order:-

PART 1

IMPLEMENTATION, CITATION AND DEFINITIONS

1. This Order shall come into operation on the 5th day of May 2009 and may be cited as "The Council of the Borough of Milton Keynes (The Council of the Borough of Milton Keynes (Central Milton Keynes) (On-Street Specific and Permit Parking Places) Order 2002) Variation Order 2009".
2. Any reference in this Order to any enactment shall be construed as a reference to that enactment as amended by any subsequent enactment.
3. The plans annexed to this Order identify the lengths of road subject to this Order, provided that where there is any inconsistency between the plans and the Articles it is the wording of the Articles which shall prevail.
4. The plans annexed to this Order are hereby annexed to The Council of the Borough of Milton Keynes (Central Milton Keynes) (On-Street Specific and Permit Parking Places) Order 2002 and form part of the Order.

PART 2

VARIATIONS

5. The Council of the Borough of Milton Keynes (Central Milton Keynes) (On-Street Specific and Permit Parking Places) Order 2002 ("The Principal Order") is varied as provided by the following provisions of this Order:-

The following item is inserted into Schedule 1 of the Principal Order as follows:-

MIDSUMMER BOULEVARD, SOUTH-EAST VEHICULAR ACCESSWAY – SOUTH-EAST SIDE

NS6 From a point opposite the north-eastern kerbline of Upper Fifth Street to the porte cochere northeast of that point.

6. The following items in Schedule 6 of the Principal Order are substituted as follows;

MIDSUMMER BOULEVARD, SOUTH-EAST SIDE VEHICULAR ACCESSWAYS – SOUTH-EAST SIDE

DP58 From the porte cochere adjacent to Number 432 Midsummer Boulevard for a distance of approximately 19 metres in a generally north-easterly direction. (4 spaces).

SOUTH FIFTH STREET – SOUTH-WEST SIDE

DP107 From a point approximately 71.4 metres south-east of its junction with Avebury Boulevard for a distance of approximately 5 metres in a generally south-westerly direction. (1 space).

7. The following item is inserted into Schedule 9 of the Principal Order as follows:-

AVEBURY BOULEVARD – SOUTH-EAST SIDE

CB5 From a point approximately 54.4 metres south-west of its junction with South Fifth Street for a distance of approximately 22.4 metres in a generally south-westerly direction.

PART 3

REVOCATIONS

8. The following Order IS HEREBY REVOKED to the extent stated below:

THE COUNCIL OF THE BOROUGH OF MILTON KEYNES (CENTRAL MILTON KEYNES) (ON-STREET SPECIFIC AND PERMIT PARKING PLACES) ORDER 2002

Item CB4 is HEREBY REVOKED IN ITS ENTIRETY from Schedule 9.

THE COMMON SEAL of the **COUNCIL OF THE BOROUGH OF MILTON KEYNES** was hereunto affixed this *30th* day of *April* 2009 in the presence of :-

18496

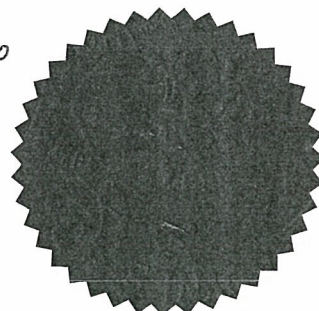

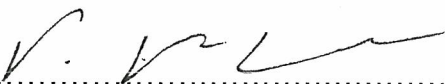

.....
HEAD OF LEGAL SERVICES AND MONITORING OFFICER

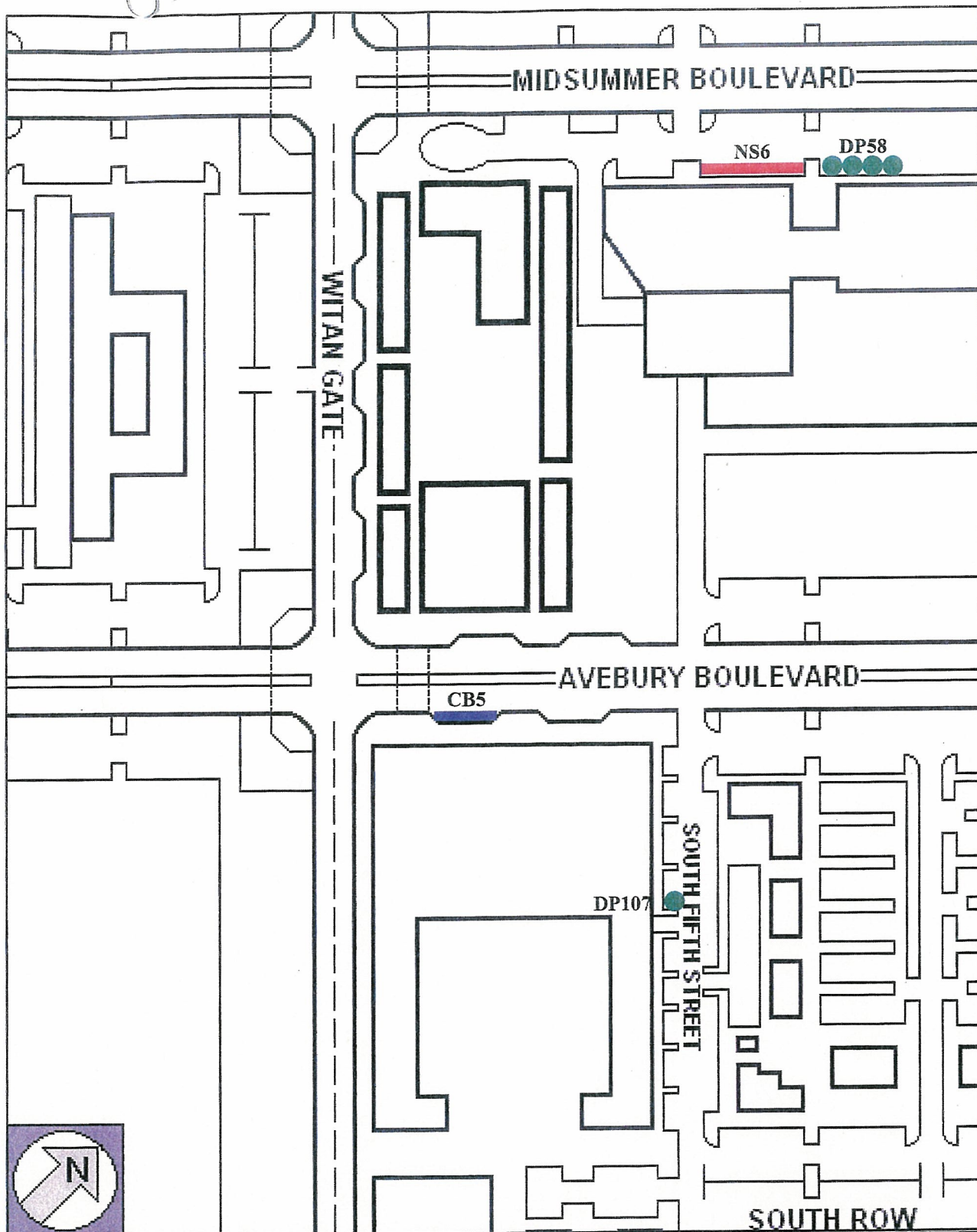

Notes:

- Taxi Rank
- NS6 TRO reference number
- Disabled persons' parking
- DP58 TRO reference number
- Community Transport parking
- CB5 TRO reference number

Map referred to in the Council of the Borough of Milton Keynes (Central Milton Keynes) (On-Street Specific And Permit Parking Places) Order 2002) Variation Order 2009

Not to Scale

The common seal of the Council of the Borough of Milton Keynes was hereunto Affixed in the presence of:

HEAD OF LEGAL SERVICES AND MONITORING OFFICER



18496